

Assembly Instructions

For Portable Lamp
Model # P3806

WARNING

- Risk of shock, do not plug in the unit before assembly.
- Do not exceed the maximum wattage rating.
- Before you begin assembly of your new fixture, please follow the instruction manual step by step.
- Lamps must total no more than 180 watts – Torchiere is Non-Compliant if it's able to draw more than 180 watts.

ASSEMBLY

1. Place all parts on a smooth, flat surface to protect the finish until ready to install.
2. Place Rubber washer (A) then Large Glass (B) on top of lamp followed by Rubber Washer (C) and steel gasket (D) secure with threaded spacer (E).
3. Install Rubber washer (F) followed by Inner Glass (G) another Washer (H) followed by Spacer (I).
4. Secure all with Check Ring (J)
5. Install the Light Bulbs in accordance with the lamp's specifications. **(DO NOT EXCEED THE MAXIMUM WATTAGE RATING. (NE PAS DEPASSER LA PUISSANCE NOMINALE MAXIMALE) .**
6. For proper and safety use, the Maximum weights of glass shape are about:
Outer Glass(B):3.15Kgs
Inner Glass(G): 0.8Kgs

The dimensions of glass shape are about:
Outer Glass(B): Min 9-1/2 in. high by min 8-3/4 in.ID at top.

Inner Glass(G): Min 8-1/2 high by min 7-1/2 in. ID at top, by min 1/8 in thick.

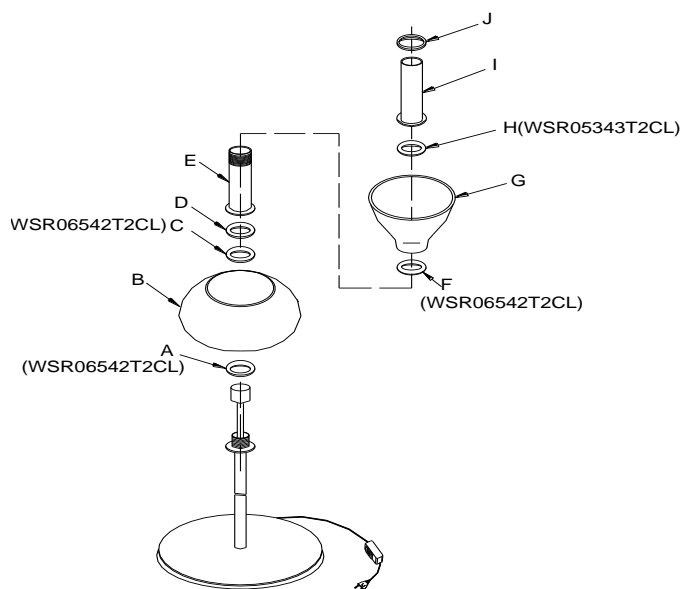

SAVE THESE INSTRUCTIONS

IMPORTANT SAFETY INSTRUCTIONS

This portable lamp has a polarized plug (one blade is wider than the other) as a safety feature to reduce the risk of electric shock. This plug will fit in a polarized outlet only one way. If the plug does not fit fully in the outlet, reverse the plug. If it still does not fit, contact a qualified electrician. Never use with an extension cord unless plug can be fully inserted. Do not alter the plug.

(Date: Sep 21.2009)
MADE IN CHINA

USER INSTRUCTION FOR 180W-LIMITED

WATTAGE USE (WITH SWITCH UNIT)

The torchiere luminaires you have purchased has a "Power Limiting Device" incorporated into the cord. This device prevents wattages higher than 180 watts. If you install a lamp above 180 watts, the device will shut down the power to the unit. In order to turn it back on, you will have to turn off the switch, check your lamp wattage, replace the lamp if necessary with a lower wattage lamp and then return the switch to "ON". The unit will reset itself in a few seconds.

In An Ongoing Effort To Be Environmentally Friendly and In Compliance with California Title 20 An Energy Saving Compact Fluorescent Bulb(s) is Included. Please Note that the Life Expectancy of The Bulb(s) is not Guaranteed.

IMPORTANT: Fixture should be installed by a qualified electrician to ensure proper wiring and installation.